



LED®

Cylinders

americanlite®

We light your world™



CLD™

21w/28w/35w
Beam Select
Power & CCT Select



Americanlite® offers specifiers a range of cylinder lighting options that complement our award-winning recessed lighting platform while providing a consistent room side aesthetic with a minimalist design.

Americanlite® CLD™ Series provides an excellent coupling of lighting performance, quality of light, and visual aesthetic. Power, Performance, and Invisibly beam adjusts from 30° to 60°; our design is the coolest thing you'll never see!

CLD™ cylinder luminaire features Professional Grade components. Made of sturdy rust-resistant aluminum, with a paint specially designed to last for years to come and 3 different color to choose.

We have incorporated our award-winning Power & CCT Selectable to spread the pallet of options to fulfill your specific project needs. State of the Art 120-347v 0-10V dimming driver paired with powerful led chips to create precise beam distributions. We kept our deep vision for long lasting products, offering a built in 4KV surge protection as standard. For mounting, you can choose surface or pendant with our optional kits.

Americanlite® CLD™ Series is the ideal choice for office, institution, healthcare, public, and retail, theaters, building entrance, and any commercial or residential applications.

Dimensions (mm)

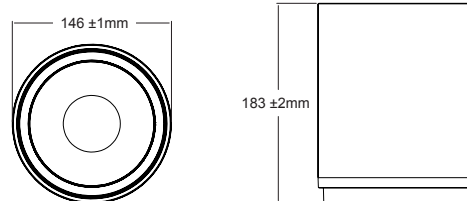

Ordering information

Model	Power Select	CCT Select	Lumens	Options	Accessories
AL682810	21w/28w/35w	2700K/3000K/3500K/4000K	2142/2856/3570	Z Bronze	AL682812 4' Pendant Kit
AL682811	21w/28w/35w	3000K/4000K/5000K/6000K	2142/2856/3570	W White B Black	AL682813 8' Pendant Kit

Notes

- Lumen Tolerance: ±10%
- Lumens based on 4K-6K
27K=86 l/w, 3K=96 l/w, 35K=107 l/w
4K=102 l/w, 5K=102 l/w, 6K=102 l/w
- Color Consistency:
27K/30K/35K/40K = <6 SDCM
30K/40K/50K/60K:
3000K = <6.0 SDCM
4000K = <6.8 SDCM
5000K = <7.6 SDCM
6000K = <6.0 SDCM
- Lumen efficacy based on 60° beam
- Beam Select:
30°/40°/50°/60°
- LED Chips:
Hongli
- Driver brand:
Weled Power
- Surge Protection:
L/N-PE: 4kV, L-N: 2kV
- 75,000 @ <Tc 65°C
- Aluminum Housing
2mm thickness
- PC Lens
- Paint thickness:
60-80 µm
- Pendant cable is:
black/white/green/purple/pink color
inner peel, wire core 5×0.824MM2
(18AWG) ,105°C, 600V

Packing information

Model	Pieces per master	Box Dimensions (cm)	CBM (Master)	Gross Weight (KG)
21w/28w/35w	6	48 x 32 x 21	0.0322	10



Warranty

Americanlite® is pleased to provide a 5 year limited warranty covering the LED fixtures on this catalogue. Americanlite® warrants that the LED fixtures comply with Americanlite®'s published specifications and are free from defects in materials and workmanship.

All our equipment is CE, ETL or UL approved and manufactured with approved components. Americanlite® reserves the right to change or improve the design or components of any of its products due to parts availability or changes in standards, without assuming any obligation to modify any product previously manufactured and without notice. All equipment is tested and inspected before shipment.

This warranty is void if the product is operated outside of its normal operating conditions. The foregoing warranty does not apply to failures caused by acts of God or as a result of any abuse, misuse, abnormal use, or use in violation of any applicable standard, code or instructions for use in installations, including, but not limited to, those contained in the Standards for the International Electrotechnical Commission. Americanlite® reserves and has the right to examine failed fixtures to determine the cause of failure, excessive lumen depreciation and patterns of usage.